



MOBILE CHANDELIER 13, 2017

Black Patinated Brass.
 Mouth blown opaline spheres.
 Pendant rod length to order.



OVERALL DIMENSIONS

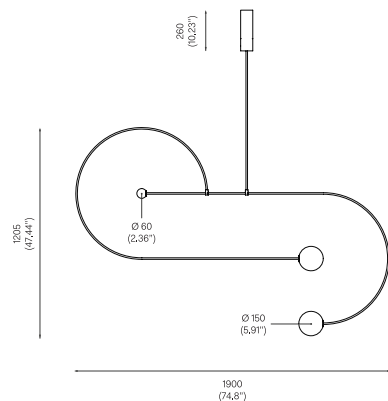

BACKPLATE DIMENSIONS

Mounting screws not included
 6mm countersunk screw recommended

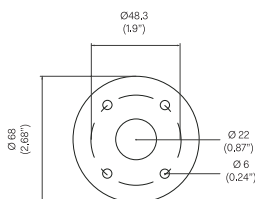

MATERIALS AND FINISHES



MA-MC13-B
 Black Patinated

BULB SPECIFICATIONS

Integrated LED, 9W for Ø 150mm sphere
 800lm / 2700K

Integrated LED, 3W for Ø 60mm sphere
 350lm / 2700K

PRODUCT SPECIFICATIONS

Maximum wattage: 22W
 120V / 240V dimmable 0~10Vdc or 10V PWM
 signal or resistance
 Product weight: 15kg

Please supply required drop length of fixture,
 measured from the ceiling to bottom of fitting
 at time of order.

Minimum total drop length 1305mm.
 Maximum total drop length 3109mm.
 Maximum total drop length with extension
 5129mm.

Please allow 25mm tolerance of drop length.

120V version supplied with paintable junction
 box cover.

Due to the handmade nature of this product
 dimensions may vary up to 10% for balancing
 purposes.

CLEANING INSTRUCTIONS

Before cleaning, lighting fixtures must
 be turned off and unplugged from mains
 electricity. Whilst cleaning please take care
 and use the gloves provided.

Black patinated: Use a dry soft dust cloth
 and gently go over marks until clean. The
 brass patina is achieved through an artisanal
 technique of applying pigments by hand
 during a hot patination process. Through this
 alchemic process, the brass is transformed
 whilst retaining the material's inherent
 qualities. It will mature and change overtime.
 The manner and speed in which it will change
 will depend on the environment, handling
 and the level and frequency of maintenance.
 Verdigris can also appear when the copper in
 the brass begins to oxidise.

Opaline Glass: Remove the opaline glass from
 the product. Using a lightly damp cloth, clean
 only the outside of the sphere. Only put the
 glass sphere back on the product once it is
 fully dry.